

SLAM SPECIALTIES SSF6-7

5845 E. Terrace Ave. Fresno, CA - 93727 - PH: 888.352.5225 FAX: 559.348.9063 www.slamspecialties.com

- Over 1" more stroke than RE Models
- Up to 40% Lighter than RE Models
- Lightest Bag in its Class
- 200 PSI Rated
- Responsive through (1) 3/8" PTC port
- Linear and Off-Axis Actuation
- Non-Ballooning Operation
- Vibration Isolation
- Load Leveling for Hauling or Towing

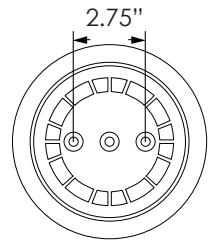
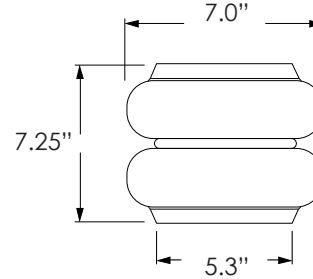
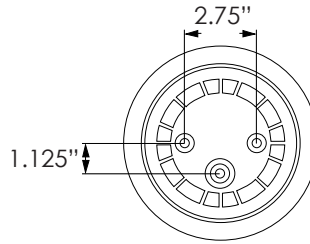

Model	SSF6-7
Diameter "0" PSI	7"
Diameter Max PSI	7"
Max PSI	200
Plate Material	Composite
Min Height	2.7"
Max Height	12"
Mounting (top)	(2) 3/8" -16
Mounting (bottom)	(3) 3/8" -16
Air Port PTC	(1) 3/8"
Internal Bump Stops	Integrated
Force to Collapse	300 lbs
Shipping Weight ea.	3.6 lbs
Replaces -	
Firestone	224
Goodyear	2B7

Dynamic Characteristics at 7.2 in. Design Height				
Gauge Pressure	Load (lbs.)	Spring Rate	Natural Frequency	
			CPM	HZ
40	-	-	-	-
60	-	-	-	-
80	-	-	-	-
100	2400	958	118.8	1.97

Lift Chart - Force In Pounds

Air Pressure

Height Inches		40	80	100	120	140	160	180	200
		3	1453	2905	3632	4358	5084	5811	6537
4	1410	2821	3526	4231	4936	5641	6346	7051	
5	1368	2737	3421	4105	4970	5474	6156	6838	
6	1327	2655	3318	3982	4646	5309	5973	6637	
7	1287	2475	3217	3860	4504	5149	5791	6435	
8	1247	2494	3117	3741	4364	4989	5611	6234	
9	1208	2415	3019	3623	4227	4833	5434	6037	
10	1169	2338	2922	3507	4091	4677	5260	5844	
11	1131	2262	2827	3393	3958	4525	5089	5654	
12	1093	2187	2733	3280	3826	4373	4919	5466	